

Models

AC2-B-BV (2-way): Auxiliary switches for D, B and S actuators.

AC2-B-BV (3-way): Auxiliary switches for D, B and S actuators.

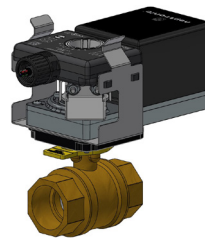

AC2-B-BV (2-way)

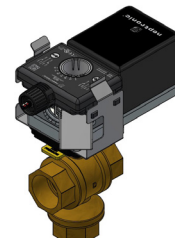

AC2-B-BV (3-way)

Technical Specification

Description	AC2-B-BV (Griswold)
Actuator Compatibility	Neptronic D, B and S series actuators
Power Supply	125VAC, 5A Resistive or 250VAC, 3A Resistive
Electrical Connection	Cable 39.5" (1m), 6 x 18AWG, FT1 with ½" conduit connector
Purpose and Action of Control	Type 1 operating control
Construction of Control	Independently mounted, accessory
Polution Degree	2
Impulse Voltage	4000V

Dimensions

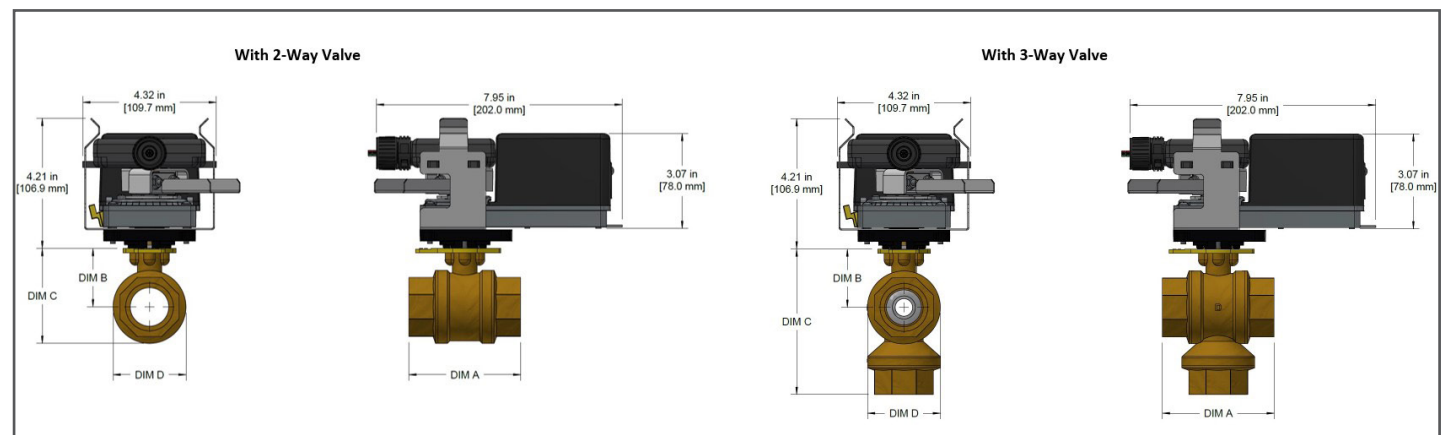

Dimensions Table							
Valve Size		Cv	Kv	Dim A	Dim B	Dim C	Dim D
½"	2-way	0.4 to 12	0.3 to 10	2.37" [60mm]	1.33" [34mm]	1.94" [49mm]	1.71" [43mm]
	3-way	0.3 to 8	0.3 to 7		1.47" [37mm]	3.34" [85mm]	
¾"	2-way	10 to 29	8.5 to 25	2.76" [70mm]	1.47" [37mm]	2.23" [57mm]	1.71" [43mm]
	3-way	3.8 to 13	3.2 to 11			3.54" [90mm]	
1"	2-way	16 to 54	14 to 46	3.04" [77mm]	1.67" [42mm]	2.57" [65mm]	1.81" [46mm]
	3-way	8.6	7.4			4.09" [104mm]	
1"	2-way	-	-	-	-	-	-
	3-way	22	19	4.03" [102mm]	1.89" [48mm]	5.04" [128mm]	2.36" [60mm]
1-1/4"	2-way	26 to 102	22 to 87	3.62" [92mm]	1.89" [48mm]	3.07" [80mm]	2.36" [60mm]
	3-way	13 to 34	11 to 29			4.70" [119mm]	
1-1/2"	2-way	41 to 172	35 to 147	4.06" [103mm]	2.22" [56mm]	3.63" [92mm]	2.83" [72mm]
	3-way	24 to 61	20 to 52			5.38" [137mm]	
2"	2-way	71 to 266	61 to 227	4.90" [125mm]	2.51" [64mm]	4.26" [108mm]	3.50" [89mm]
	3-way	38 to 56	32 to 48	4.00" [98mm]	2.22" [56mm]	5.35" [136mm]	2.83" [72mm]
2"	2-way	-	-	-	-	-	-
	3-way	83 to 108	71 to 92	5.00" [127mm]	2.51" [64mm]	6.36" [162mm]	3.50" [89mm]
2-1/2"	2-way	101 to 202	86 to 173	5.35" [136mm]	2.51" [54mm]	4.26" [162mm]	3.50" [89mm]
	3-way	74 to 99	63 to 85			6.59" [167mm]	
3"	2-way	124 to 145	106 to 124	5.73" [146mm]	2.51" [54mm]	4.52" [115mm]	4.02" [102mm]
	3-way	-	-	-	-	-	-

Wiring Diagram

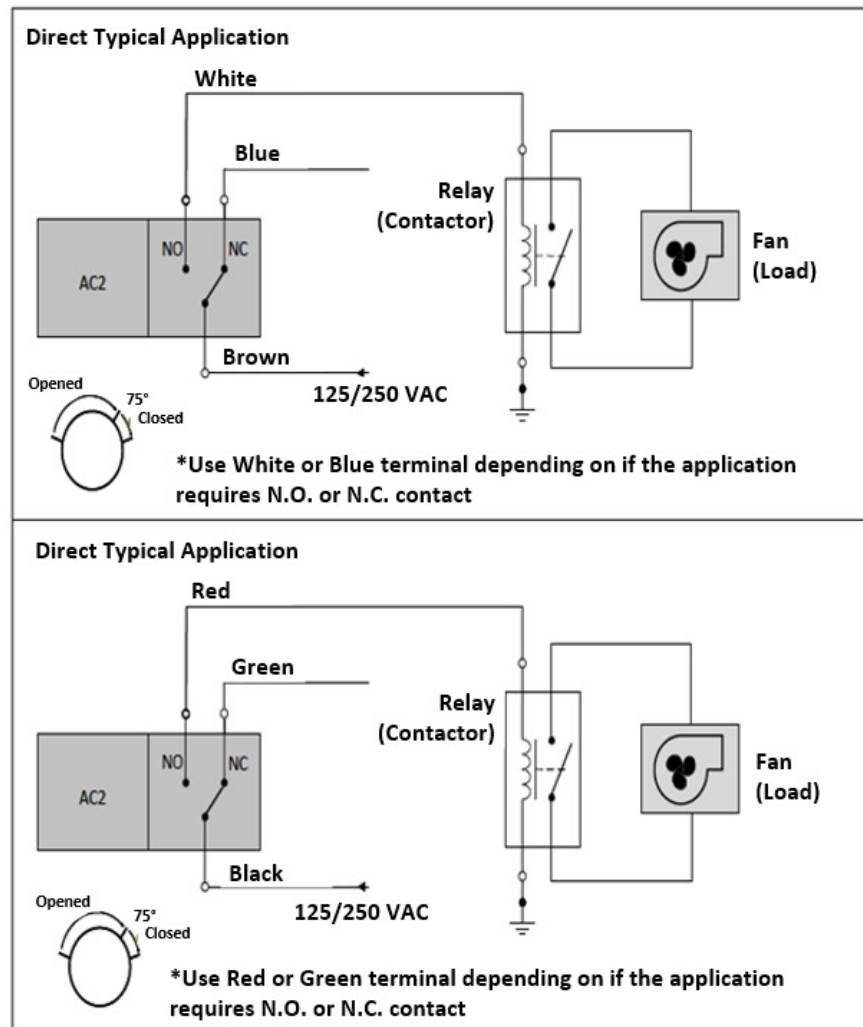

The auxiliary switch comes factory preset: 10° - 80°

Mounting Instruction

Before beginning installation, ensure to set the actuator at a 45° position.

1. Attach the BB Handle (1) onto the actuator (2) and secure it in place by using 2 nuts.

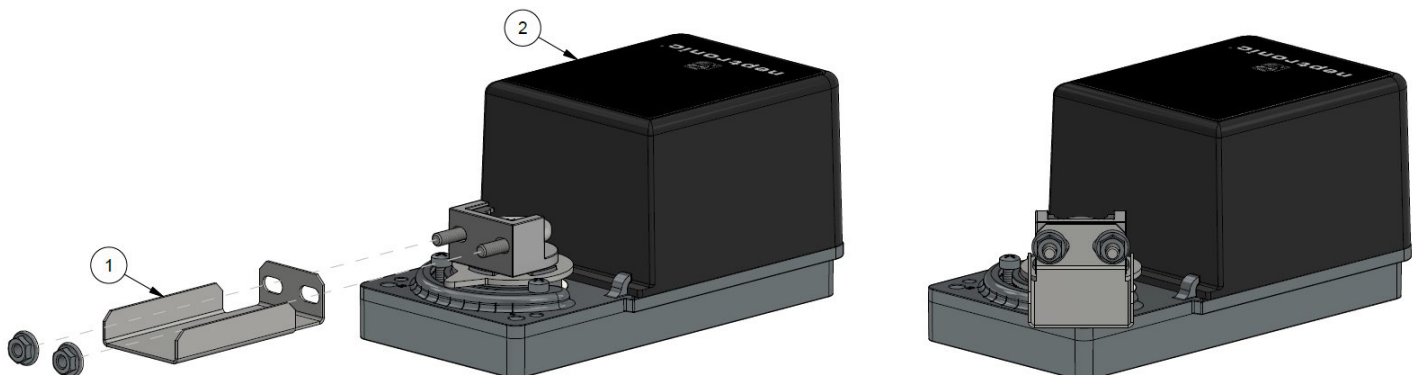

- Place the BB bracket (4) and square aluminum extrusion (5) onto the valve (6) and secure the assembly by using two M4x0.7 bolts (3).

Note: The square aluminum extrusion (5) is a press to fit object, if it doesn't fit properly, use a clamp (not supplied) to secure it.

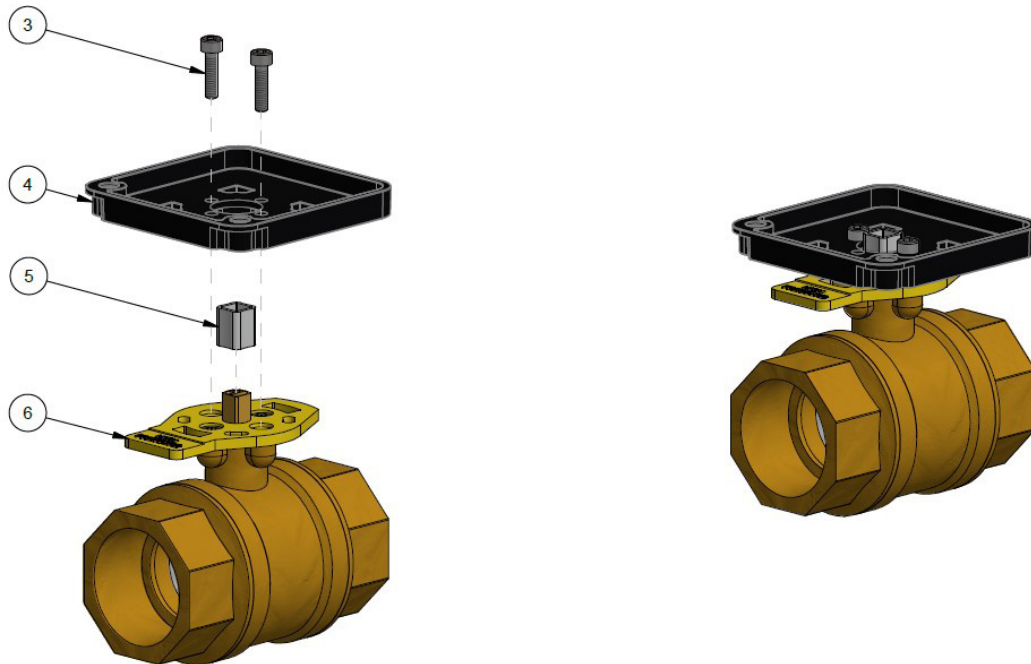

- Place the brass shaft (9) onto the BB bracket (4) and valve assembly. Place the AC2 bracket (8) and Actuator assembly from step 1 onto the brass shaft and secure the assembly using two pan head screws (7) and two 8-32 hex nuts (10).

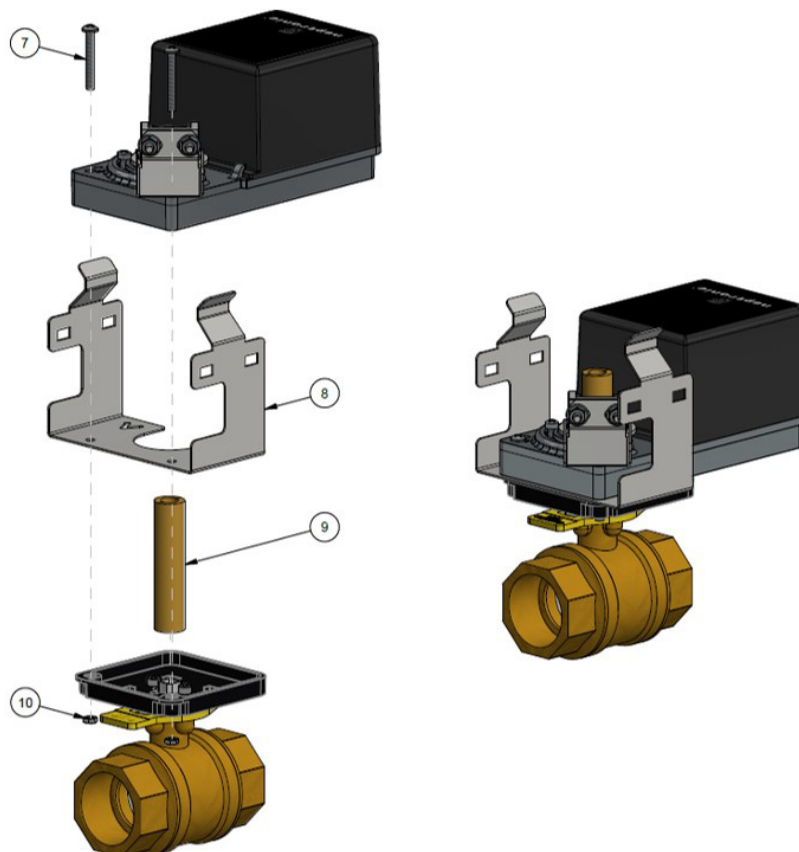

- Attach the AC2 (11) onto the brass shaft (9) and ensure that the AC2 is properly snapped in place.

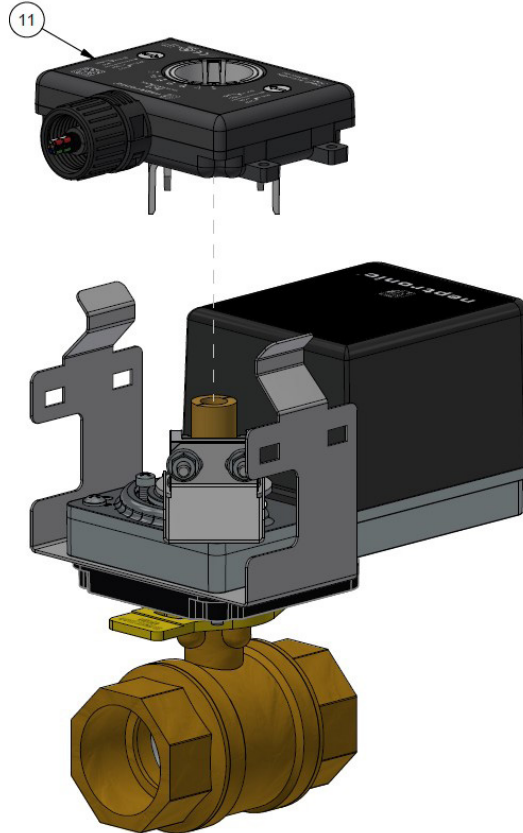

Actuator Positioning

- Turn the dial on the auxiliary switch to the desired position for the actuator lower contact.
- Using a flathead screwdriver, turn the left arrow on the auxiliary switch so that the arrowhead is aligned with the arrow on the wiring diagram.

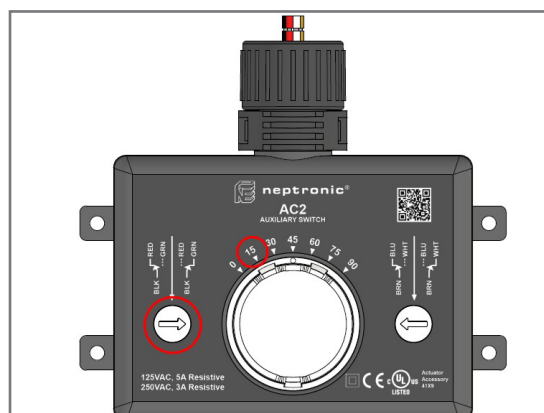

15° Position

- Turn the dial on the auxiliary switch to the desired position for the actuator upper contact.
- Using a flathead screwdriver, turn the right arrow on the auxiliary switch so that the arrowhead is aligned with the arrow on the wiring diagram.



Recycling at end of life: please return this product to your Neptronic local distributor for recycling. If you need to find the nearest Neptronic authorized distributor, please consult www.neptronic.com.